

## 5-Cylinder 2.3 20V V5 VR5 X-beam connecting rod Main Sizes

Brand: Hurricane	
Center to Center Length: 164mm/6.457"	
Big End Bore Diameter: 56.80mm/2.236"	
Big End Width: 19.88mm/0.783"	
Small End Bore Diameter: 20.01mm /0.788"	
Small End Width: 19.90mm/0.783"	
Beam Style: X-beam	

## Volkswagen connecting rod (VAG) AQN/AZX 2.3 Ltr 20V V5 Features

Connecting Rod Bolt Diameter	<a href="#">5/16 "</a>
Approximate Connecting Rod Weight	xxxg
Advertised Horsepower Rating	1000hp
Quantity	Sold as 5 pieces /set
Material	<a href="#">Forged 4340 steel</a>
Connecting Rod Finish	Shot-peened, Polished
Pin	Bronze wrist pin bushings
Wrist Pin Style	Floating
Cap Retention Style	Cap screw
Weight Matched Set	Yes ,Balanced +/- 1g
Magnafluxed	Yes
Private Label	Yes ,available
Custom design	Yes, accept

## VW Bora 2.3 Ltr V5 20V 5 Cyl X-beam rods Description

### X-Beam design

this feature allows more strength than H-beam.

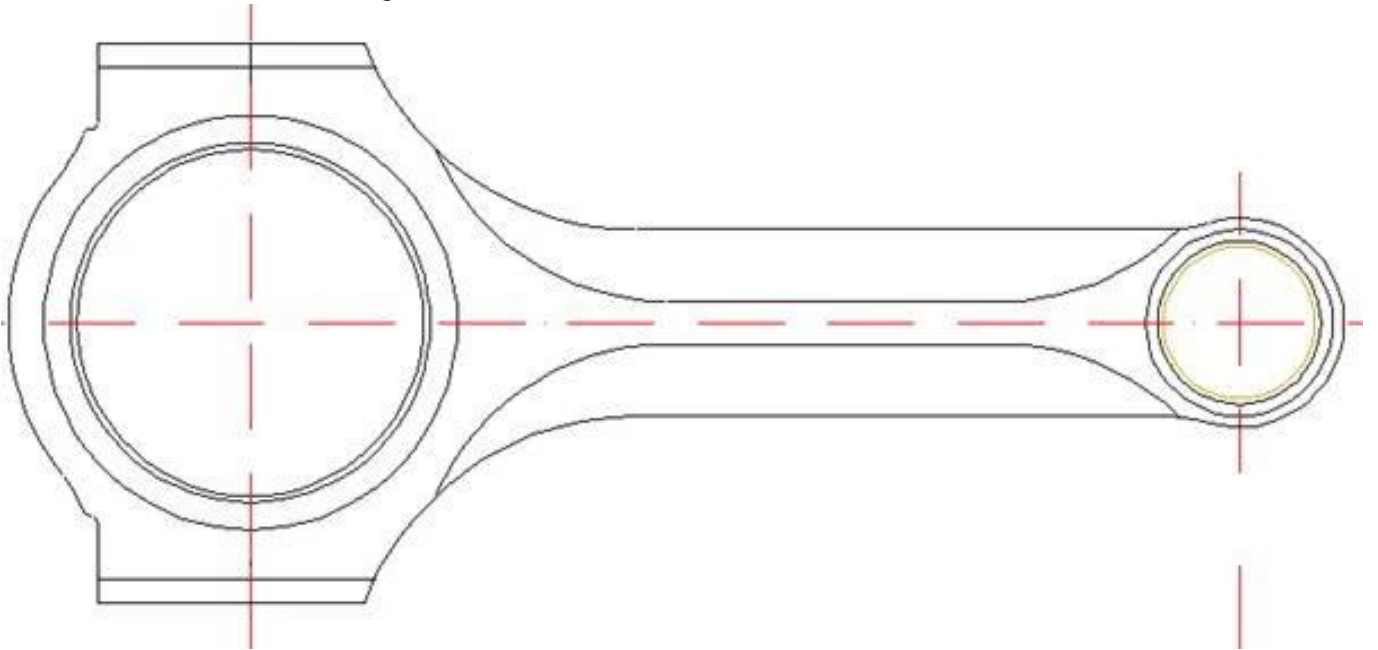

### **Professional design engineers**

All rods are designed specifically for the application with professional engineers, who design rods over 20years.

### **Rifle dirrled**

Also referred to as Forced Pin Oiling (FPO), rifle drilling increases wrist pin longevity by providing additional lubrication. This upgrade is highly recommended for street-driven cars that see mileage put on them. Rifle drilling is an additional procss and sold separately on this application.



### **Honed bore**

Honing the connecting rod big end bore and small end bore, which you could use directly when you get them.

### **Material forged 4340 steel**

Made from strong and one-piece 4340 forgings ,these rods will withstand almost everything you can throw at them.

### **ARP2000 bolt**

All rods deisgned and made for standard with ARP 2000 rod bolts. Ensure that you could get bolt easliy

### **Arp2000 bolt torque specs**

Generally, 45N\*M. Of course, we will assemble and honing bore with your special torque if necessary